

**PRODUCT CODE**

ZSLIM70D2WH / ZSLIM70D2WHM



|  |   |
|--|---|
| <b>Dimensions</b>                          | W 710      x H 618      x D 390      (mm)   |
| <b>Finishes</b>                            | White Gloss Paint or Melamine.  |
| <b>Basin</b>                               | Vitreous China Top with Semi-Circle Basin   |
| <b>Pull Handle</b>                         | Chrome, Black, Chrome Box or Chrome Mini.   |
| <b>Profile Handle*</b><br><i>(Upgrade)</i> | Brushed Nickel, Brushed Anthracite, Satin Brass or Matte Black.   |
| <b>Origin</b>                              | New Zealand made cabinetry.   |
| <b>Features</b>                            | <ul style="list-style-type: none"> <li>• Slim top, semi-circle basin for smooth water flow.</li> <li>• 2 Drawers with soft-close &amp; choice of handle.</li> <li>• Timber effect melamine is a low-pressure laminate.</li> <li>• The paint is polyurethane or UV based.</li> </ul> |

**Top**

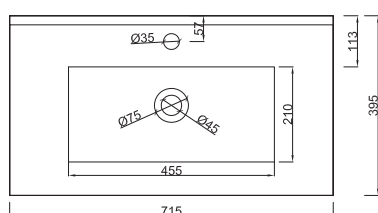

Technical drawing of a rectangular frame. The dimensions are indicated as follows:

- Width: 710
- Height: 1025
- Base: 690

Technical drawing of a rectangular frame. The overall height is 292. The overall width is 55. The internal width is divided into two sections: 122 and 242.

\*Additional Cost. Accessories not included. Drawing indicates the technical measurement only and is not a reflection of how the product will look. Sizes are nominal only. Due to the firing process and natural variation in ceramic tops, all sizes are nominal and may vary slightly in shape and dimensions. All drawings in millimeters. Drawings not to scale. July 2025.