

DESCRIPTION

Qubo 1200 Wall-Hung Vanity, 2 Drawers, White / Timber Veneer

PRODUCT CODE

QU120D2WH / T



FEATURES

- Dimensions - W 1210mm x H 500mm x D 440mm
- Available in painted White, Timber Veneer*, or your choice of paint colour.^
- Available in 4 other style finishes.
- The paint used on our products is polyurethane or UV based. It is five times harder and more durable than lacquer finishes.
- Timber veneer finishes are 100% natural, so each have variations in grain and colour. All come stained and sealed with a protective UV finish.
- Soft-close drawers.
- Italian-made, ceramic top. NZ-made cabinetry.

PAINT / TIMBER VENEER FINISHES*

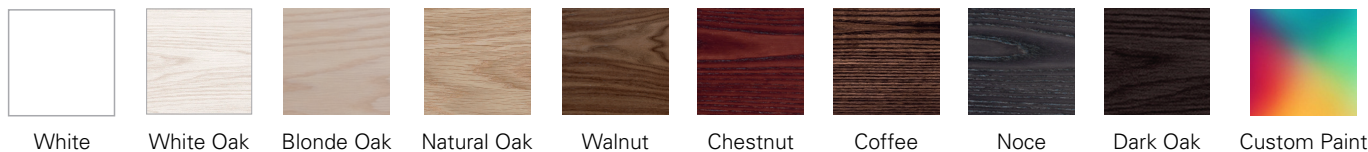

AVAILABLE IN OTHER STYLE FINISHES



Contrasting Rail
with White / Timber Veneer
(CT)



Vertical Grooves
with White / Timber Veneer
(VG / TVG)



Timber Veneer Cabinet
with Painted Drawer
(PT)



Painted Cabinet with
Timber Veneer Drawer
(PTD)

NOTES

Please see reverse for technical drawings.

*Non-stock item. ^15% surcharge applies for custom paint colour, 25% for metallic and black gloss.

DESCRIPTION

Qubo 1200 Wall-Hung Vanity, 2 Drawers, White / Timber Veneer

PRODUCT CODE

QU120D2WH / T

TECHNICAL DRAWINGS

Top

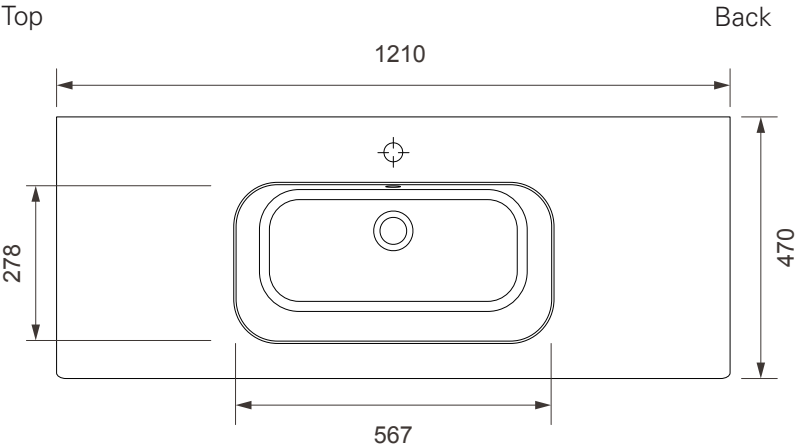

Back

Front

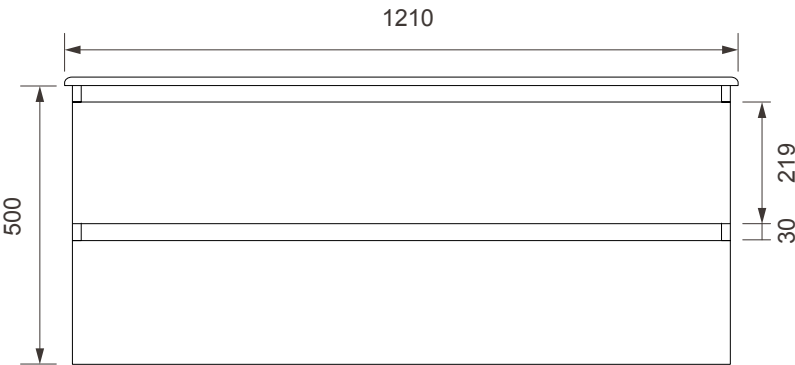

Side Section

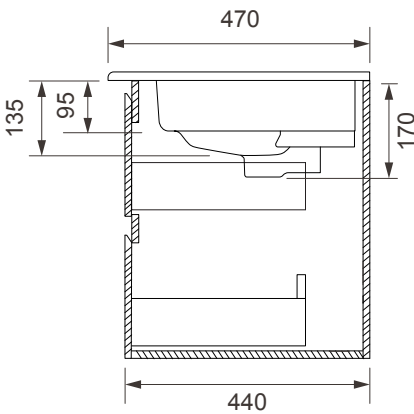

Top Section of Drawer

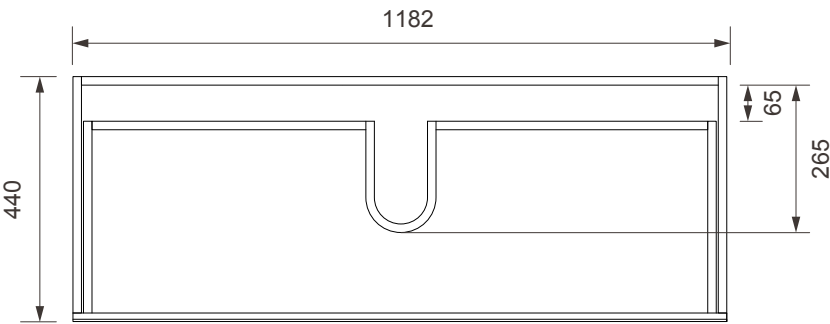

NOTES

Drawing indicates the technical measurement only and is not a reflection of how the unit will look. Sizes are nominal only. All drawings in millimeters. Drawings not to scale.