

DESCRIPTION

Soft 800 Wall-Hung Vanity, 2 Drawer, White / Melamine

PRODUCT CODE

FT80D2WH / M



FEATURES

- Dimensions - W 805 x H 620 x D 455mm
- Available in White or Melamine*
- The paint used on our products is polyurethane or UV based. It is five times harder and more durable than lacquer finishes.
- Timber Effect Melamine: Our wood grain melamine is a low-pressure laminate.
- Soft-close drawers.
- Available with Silver or Black Aluminium Rails. Or with the Semi Handle (H2) (additional cost).
- Price includes basin & cabinet, excludes tapware & accessories.

PAINT / MELAMINE* FINISHES



White Paint



Nordic Ash



Driftwood

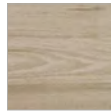

French Oak



Manhattan
Elm



Southern
Oak



Charred Oak

TECHNICAL DRAWINGS

Top

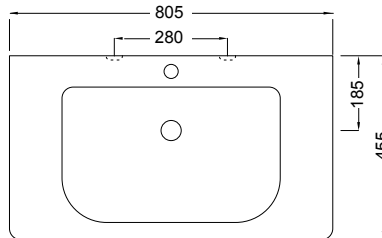

Section Top of Drawer

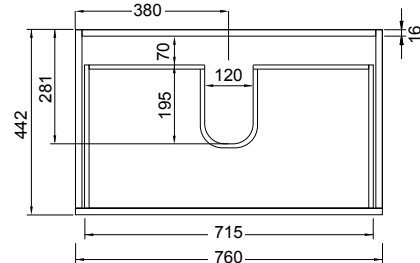

Front

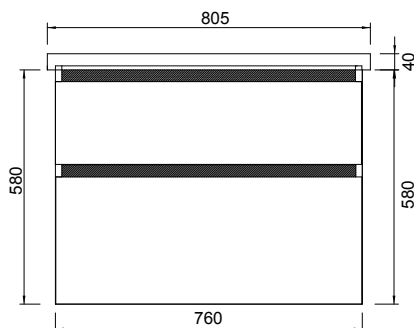

Side

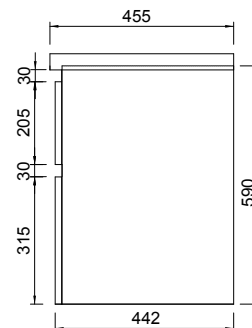

NOTES

*Non-stock item. Drawing indicates the technical measurement only and is not a reflection of how the product will look. Sizes nominal only. Drawings in millimeters, not to scale. August 2019.