

DESCRIPTION

Soft Solid Surface 1760 Wall-Hung – 2 Drawers, Double Bowls, White / Melamine

PRODUCT CODE

FT1760D2WHSS / M



FEATURES

- Dimensions: W 1760 x H 461 x D 460 mm
- Available in White paint (Gloss) or Melamine
- The paint used on our products is polyurethane or UV based. It is five times harder and more durable than lacquer finishes.
- Our Timber Effect Melamine is a low-pressure laminate.
- Soft-close drawer/s with handle-less design. NZ-made cabinetry.
- Deeper bottom drawers for more convenient storage.
- Available with Aluminium Rail/s (Silver or Black) for a contrasting finish. Or pair with Semi Handle/s (H2) (additional cost).
- Solid White 20mm Kordura top.
- Pair with our Sleek counter-top or Moon counter-top basins.
- Double bowl or offset single bowl.

PAINT / MELAMINE FINISHES



White Paint
(Gloss)



Nordic Ash

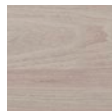

Driftwood

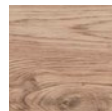

French Oak



Manhattan
Elm

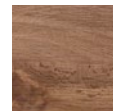

Southern
Oak

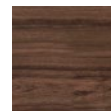

Hickory
Walnut

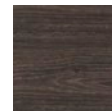

Black Forest

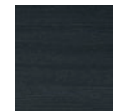

Charred Oak

TECHNICAL DRAWINGS

Top

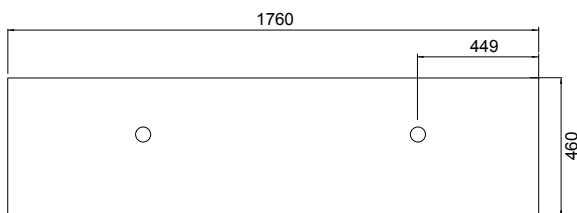

Top Section of Drawer

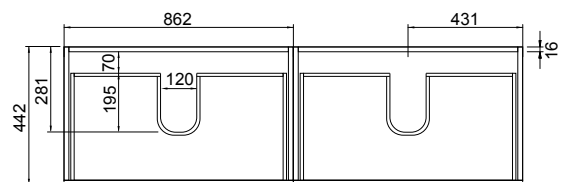

Front

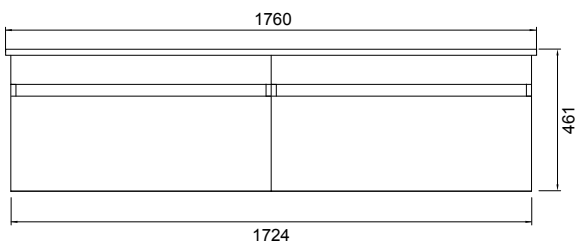

Side Section

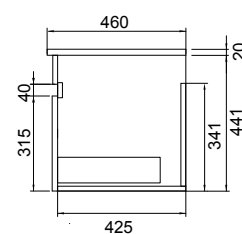

NOTES

• Made to order in NZ. • Single bowls must be offset left or right. • Must use bottle traps to ensure drawers open, we recommend 40551-32 bottle trap. • Please use a contoured waste with all china basins, we recommend Basin Waste with Click-Clack Push Button (Unslotted) (W22). • Tap holes do not come pre-drilled – this is the responsibility of the installer, and can be cut with a hole saw, jigsaw or router • Drawing indicates the technical measurement only and is not a reflection of how the product will look. Sizes nominal only. Drawings in millimetres. Not to scale • Tap ware & accessories not included. January 2020.