

DESCRIPTION

Soft Solid Surface 1550 Wall-Hung – 2 Drawers, Double Bowls, White / Melamine

PRODUCT CODE

FT1550D2WHSS / M



FEATURES

- Dimensions: W 1550 x H 461 x D 460 mm
- Available in White paint (Gloss) or Melamine
- The paint used on our products is polyurethane or UV based. It is five times harder and more durable than lacquer finishes.
- Our Timber Effect Melamine is a low-pressure laminate.
- Soft-close drawer/s with handle-less design. NZ-made cabinetry.
- Deeper bottom drawers for more convenient storage.
- Available with Aluminium Rail/s (Silver or Black) for a contrasting finish. Or pair with Semi Handle/s (H2) (additional cost).
- Solid White 20mm Kordura top.
- Pair with our Sleek counter-top or Moon counter-top basins.
- Double bowl or offset single bowl.

PAINT / MELAMINE FINISHES

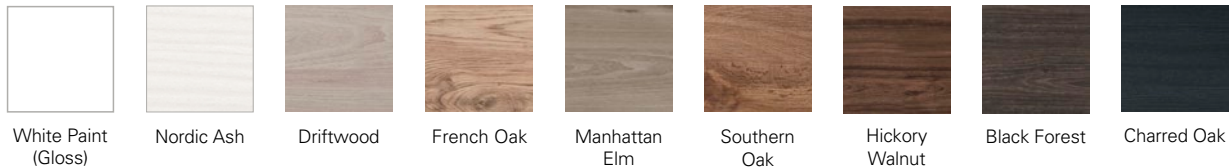

TECHNICAL DRAWINGS

Top

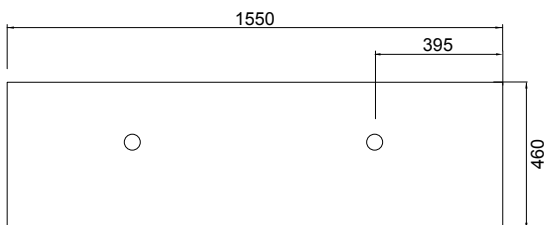

Top Section of Drawer

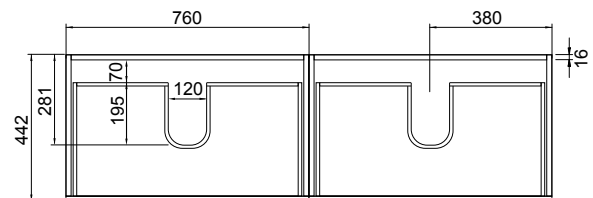

Front

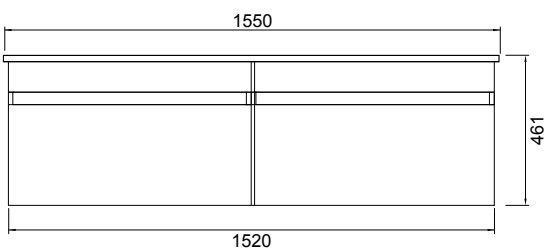

Side Section

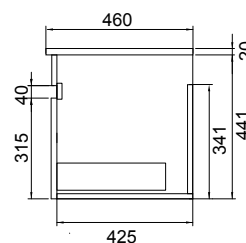

NOTES

- Made to order in NZ.
- Single bowls must be offset left or right.
- Must use bottle traps to ensure drawers open, we recommend 40551-32 bottle trap.
- Please use a contoured waste with all china basins, we recommend Basin Waste with Click-Clack Push Button (Unslotted) (W22).
- Tap holes do not come pre-drilled – this is the responsibility of the installer, and can be cut with a hole saw, jigsaw or router.
- Drawing indicates the technical measurement only and is not a reflection of how the product will look. Sizes nominal only. Drawings in millimetres. Not to scale.
- Tap ware & accessories not included. January 2020.