

DESCRIPTION

Accessible Wall-faced Toilet

PRODUCT CODE

COVWFWH



FEATURES

- Dimensions - W360 x H440 x D800 mm
- Toilet includes seat (no lid). Floor-fix screw and elbow. Pneumatically controlled K301Q-D cistern and K5212M-Q flush Plate.
- Vitreous china, rimless design, glazed rim and trap.
- Removable seat with stainless steel hinges.
- Efficient 4.5/3 litre flush distribution.
- 4 Star WELS rating.
- P-Trap pan, and comes with S-Trap Connector (284.M.30846).

TECHNICAL DRAWINGS

Side View of Pan

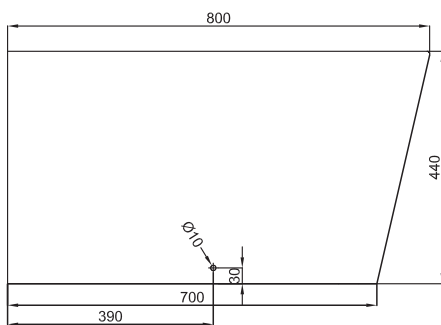

Front View of Pan

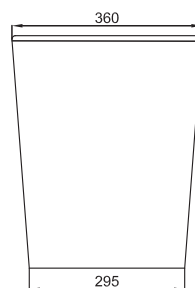

Suite Section of Pan

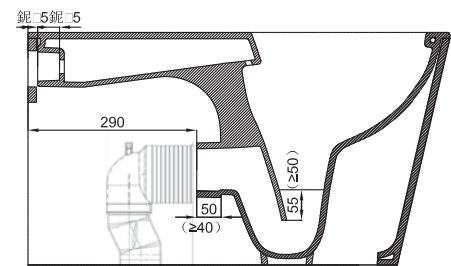

Top View Pan

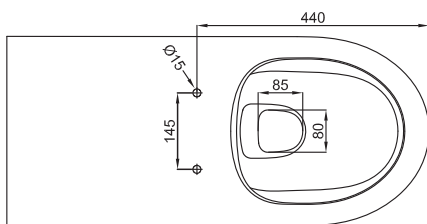

Bottom View Pan

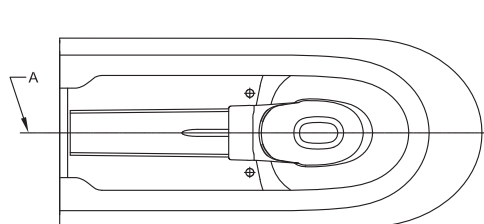

Back View of Pan

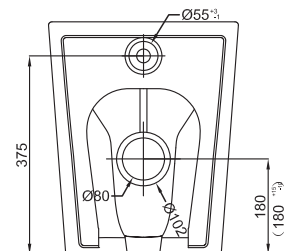

NOTES

Drawing indicates the technical measurement only and is not a reflection of how the unit will look. Sizes are nominal only. All drawings in millimeters. Drawings not to scale. November 2022.