

Instruction Manual

Please check the components in accordance with the table list below. Any shortage, please contact the local agent.

The appearance of the products can vary according to different models. Below drawing is for reference only.

Warning: Please ensure there are no hidden service pipes or cables where you intend to drill !

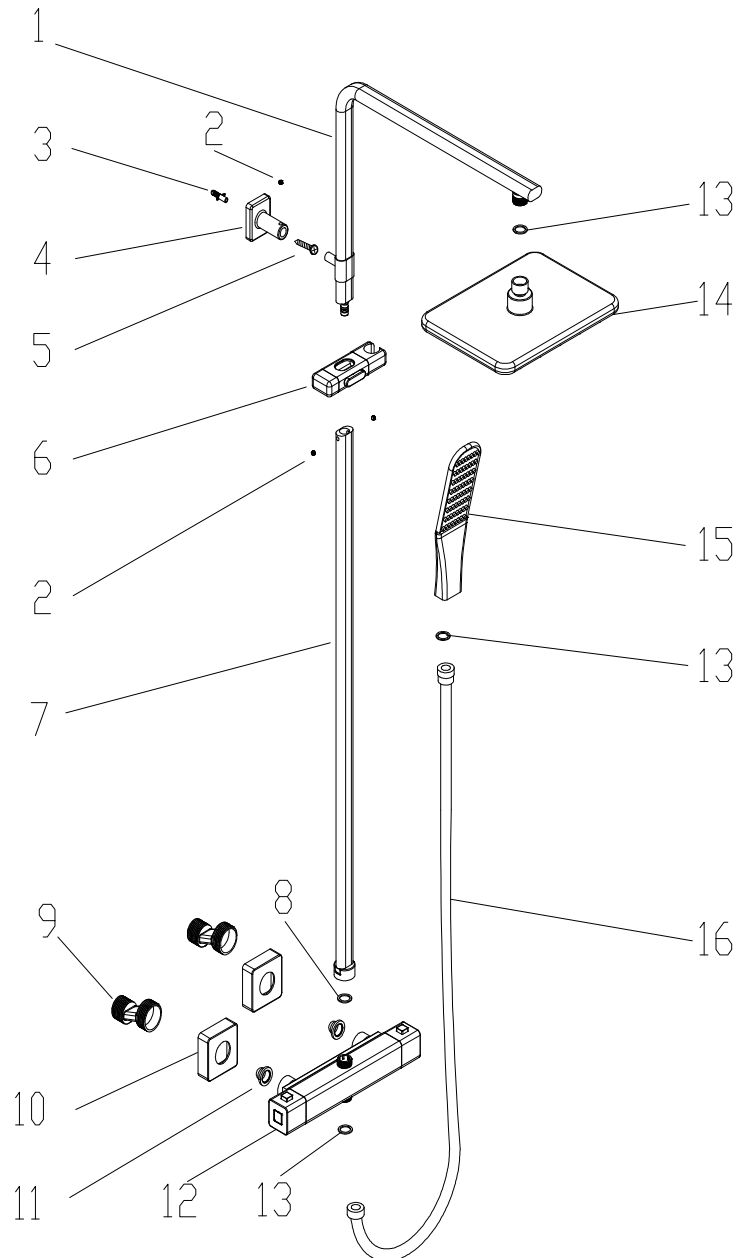

Part List

<i>No.</i>	<i>Part Name</i>	<i>Qty</i>
01	<i>Curve arm</i>	1
02	<i>Fixing Screw</i>	4
03	<i>Plug</i>	1
04	<i>Wall bracket</i>	1
05	<i>Screw</i>	1
06	<i>Slider</i>	1
07	<i>Riser tube</i>	1
08	<i>Rubber gasket</i>	1
09	<i>S-connectors</i>	2
10	<i>Wall cover</i>	2
11	<i>Rubber gasket with filter</i>	2
12	<i>Mixer</i>	1
13	<i>Rubber gasket</i>	3
14	<i>Fixed shower</i>	1
15	<i>Handshower</i>	1
16	<i>Hose</i>	1

① *Drill one hole about 836 mm above the inlet holes on the wall. Mount the two S-connectors(9) in the two water inlet holes.*

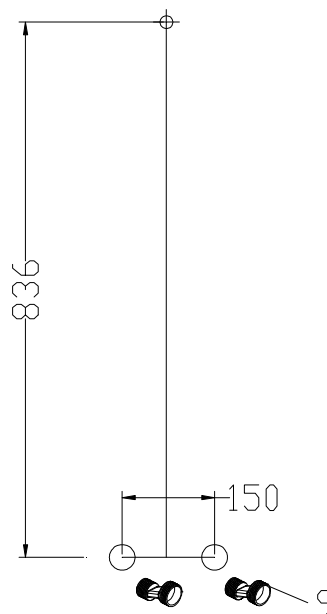

② *Insert the plugs (3) into the wall, fix the wall bracket (4) with the screw (5) on the wall , and mount the mixer(12) on the wall*

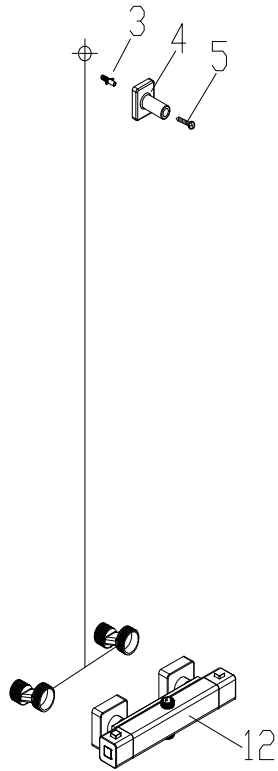

③ Assemble the slider (6), riser tube (7) and curve arm (1). Adjust the connecting sleeve to the suitable position, and fix the curve arm and connecting sleeve by screw (2)

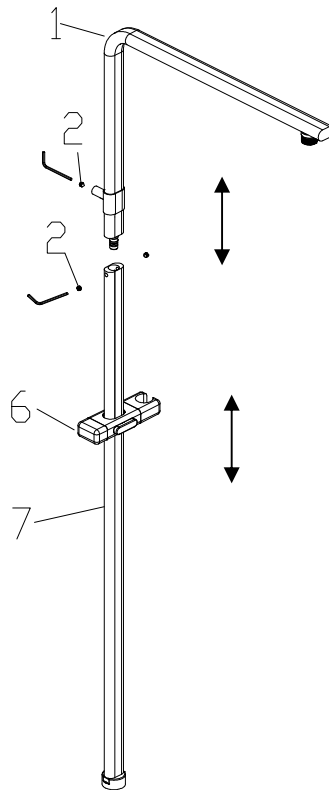

④. Screw the nut and rubber gasket (8) on the mixer, and fix the connecting sleeve in the wall

bracket by fixing screw (2).

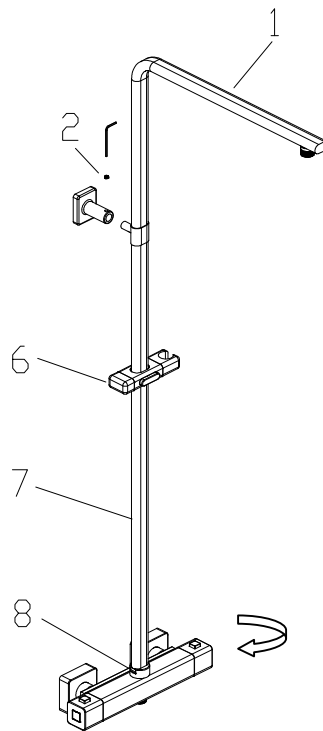

⑤ *Fix the fixing shower (14), handshower (15) and hose (16), adding rubber gaskets inside.*

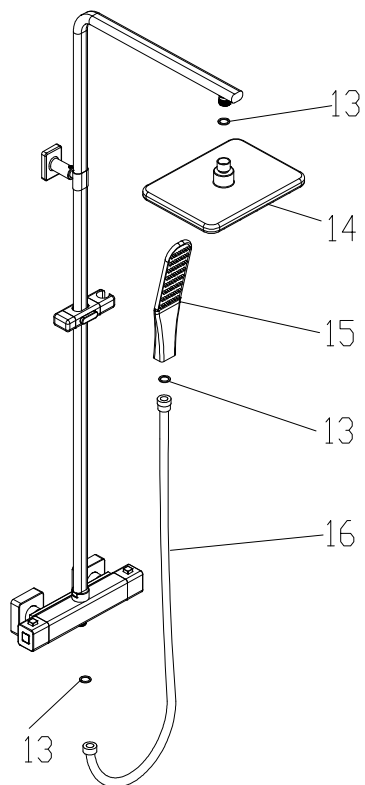

1. Replace cartridge

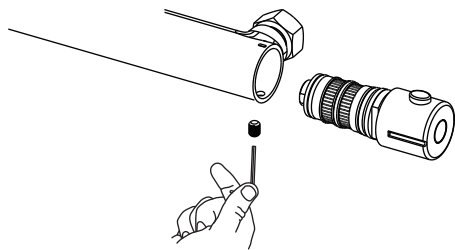

Step 1: Remove the grub screw and take out the cartridge.

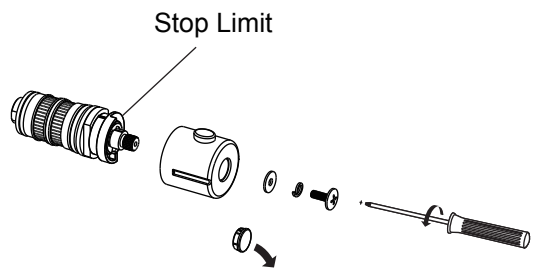

Step 2: Separate the handle from the cartridge, remove the stop limit.

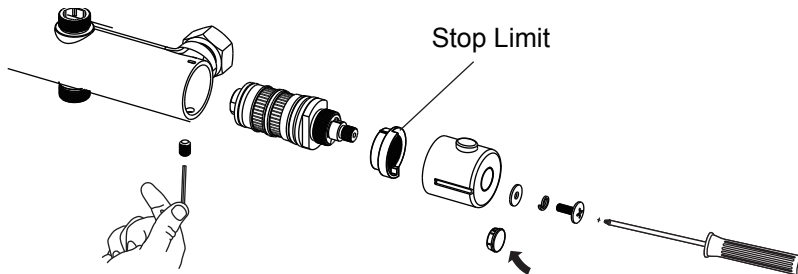

Step 3: Put the new cartridge into the valve body, and put the stop limit and handle back in sequence. Set the temperature (refer to section "Temperature Setting").

2. Temperature Setting - If the temperature does not come up to 38 degrees please confirm the following settings before calling the merchant to report a problem

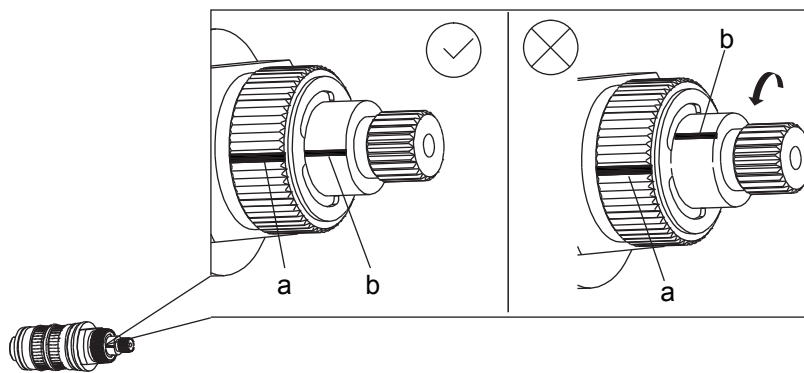

Step 1: Align the blank marks on part a and b.

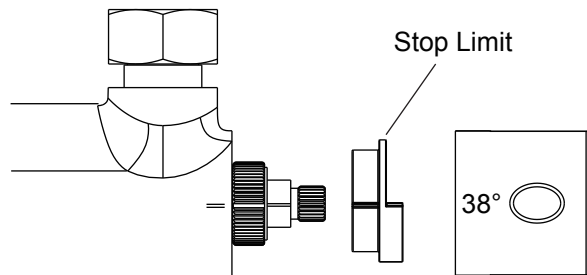

Step 2: Put the stop limit back onto the cartridge. Ensure that the black mark on the stop limit aligns with the mark on the cartridge. Put the handle back on and ensure the etching on the valve body aligns with the mark on the cartridge and etching on the handle.

Working Conditions

1. Water quality: Lime scale may affect the cartridge function over time.
2. This valve is a thermostatic mixing device and therefore requires the water supplies to be balanced. Whilst the unit will function on a low pressure system, flow rates will be affected especially through the dump shower so the recommendation is to run this on balanced hot and cold water pressure 2bar and above.
3. For the hot water, the recommended temperature is between 55 and 65°C. If it goes above 65 degrees, then it will affect the cartridge over time and void any warranty.