

1340 curved

Burlington®

DESCRIPTION

Freestanding 1340 Curved Matt White Vanity Unit, White Top

PRODUCT CODE

FC4W-WT



FEATURES

- Dimensions - W 1335mm x H 850mm x D 550mm
- Unit comes with fully assembled, 2 soft-close drawers & doors and chrome plated metal handles.
- A lacquered top coat with 5 layers of primer featuring UV stabilization to minimize colour fading from exposure to sunlight.
- The plinths of the freestanding furniture are crafted from HDP Polymer, a waterproof base
- Kordura tops are supplied with the integrated Inset basin with overflow.
- Kordura tops do not come with predrilled tapholes. This is the responsibility of the installer to drill in the required position and configuration, and can be cut with a hole saw. A template is provided with the Kordura tops indicating tap hole positions and sizes.

TECHNICAL DRAWINGS

Top

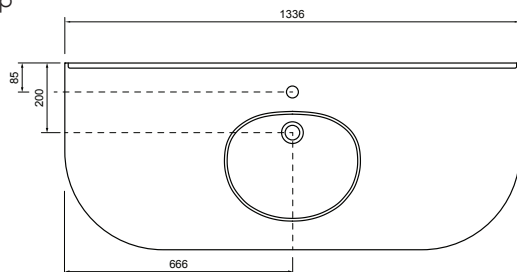

Drawer Section

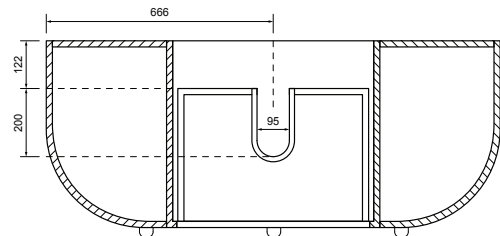

Front

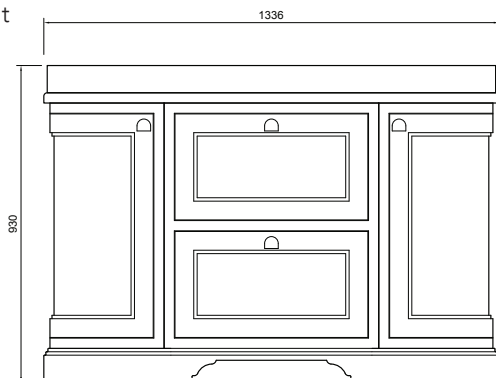

Side Section

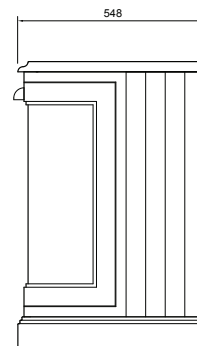

NOTES

Drawing indicates the technical measurement only and is not a reflection of how the unit will look. Sizes approximate. All drawings in millimeters.